



April 2016 - Revision B
Quick Coupling Division
 8145 Lewis Road
 Minneapolis, MN 55427
 phone 763 544 7781
 fax 763 544 3418

SUBSEA COUPLING SOLUTIONS

DST Series Data Sheet



DST Series are unvalved, straight through couplings with unrestricted flow. Redundant interface sealing ensures reliable performance.

Features:

- Sizes 1/4" - 3/4"
- Up to 8000 psi (552 bar)
- Unvalved, straight through design
- Redundant sealing
- O-ring/back up primary seal, secondary slipper seal
- Body materials: Nitronic® 50HS and 316 SST

Options:

- Various O-ring materials
- End configurations: Compression, JIC (others available upon request)

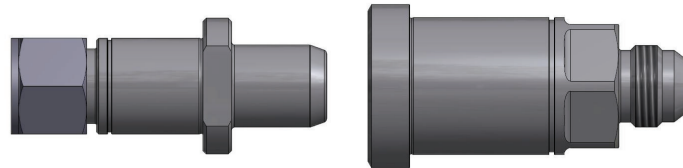

Size	Working Pressure*** (psi/bar)	Rated Working Depth** (ft/m)	Cv per Coupling Half	Separation Force (lb/1000 psi & N/100 bar)	Water Ingress Per Connect (ml)	Length* (in/mm)	Min. Plate Bore Diameter* (in/mm)
1/4"	8000/552	12,000/3658	5.1	196/1265	Unvalved	Male: 2.50/63.5	.629/15.98
						Female: 2.56/65.0	.885/22.48
1/2"	8000/552	12,000/3658	16.8	442/2852	Unvalved	Male: 2.57/65.3	.879/22.33
						Female: 2.76/70.1	1.260/32.00
3/4"	8000/552	12,000/3658	31.8	785/5065	Unvalved	Male: 2.89/73.4	1.504/38.20
						Female: 3.12/79.2	1.510/38.35

Data given is representative of the coupling series. Individual couplings may vary based on specific configuration of fittings/optional features.

* Minimum bore diameter and length are reference. May change for a specific plate configuration.

** Mate/demate topside only.

*** Max. pressure rating dependent on end configuration.